

Soils Map

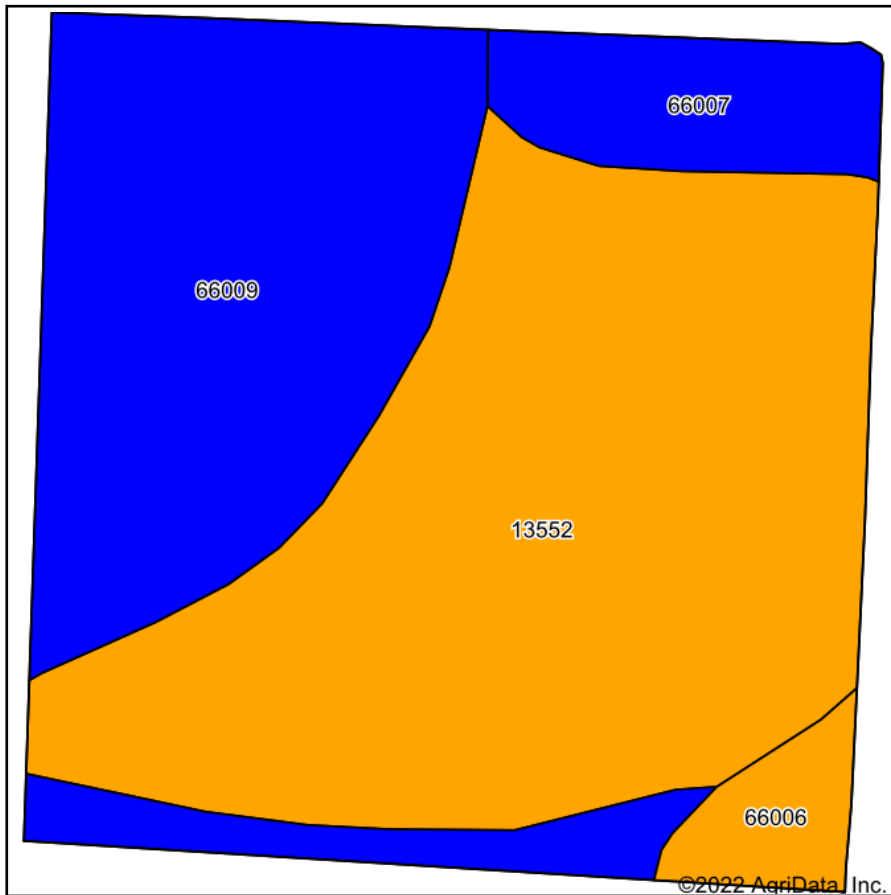

Soils data provided by USDA and NRCS.

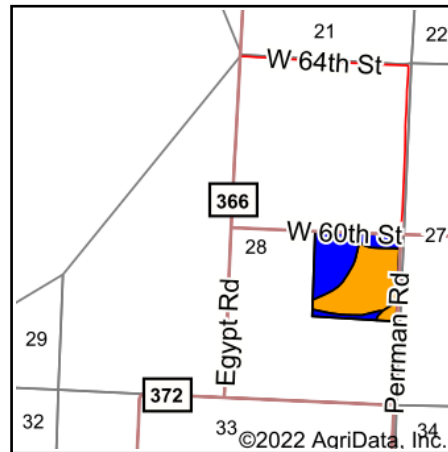

State: **Missouri**
 County: **Ray**
 Location: **28-51N-29W**
 Township: **Orrick**
 Acres: **40.1**
 Date: **7/19/2022**

United Country
 Property Solutions, LLC

Maps Provided By:

 CUSTOMIZED ONLINE MAPPING
 © AgriData, Inc. 2021 www.AgriDataInc.com



Area Symbol: MO177, Soil Area Version: 21

Code	Soil Description	Acres	Percent of field	Non-Irr Class Legend	Non-Irr Class *c	Common bermudagrass Tons	Orchardgrass red clover Tons	Tall fescue Tons	Warm season grasses Tons	*n NCCPI Overall	*n NCCPI Corn	*n NCCPI Soybeans
13552	Modale silt loam, 0 to 2 percent slopes, occasionally flooded	21.45	53.5%		IIIw	7	9	8	10	49	46	48
66009	Haynie silt loam, 0 to 2 percent slopes, occasionally flooded	12.60	31.4%		IIw					60	60	54
66007	Leta silty clay, 0 to 2 percent slopes, occasionally flooded	4.70	11.7%		IIw	7	7	8	9	55	54	50
66006	Waldron silty clay loam, 0 to 2 percent slopes, occasionally flooded	1.35	3.4%		IIIw	7	7	8	9	56	54	55
Weighted Average					2.57	4.8	5.9	5.5	6.7	*n 53.4	*n 51.6	*n 50.4

*n: The aggregation method is "Weighted Average using all components"

*c: Using Capabilities Class Dominant Condition Aggregation Method

Soils data provided by USDA and NRCS.