

Soils Map

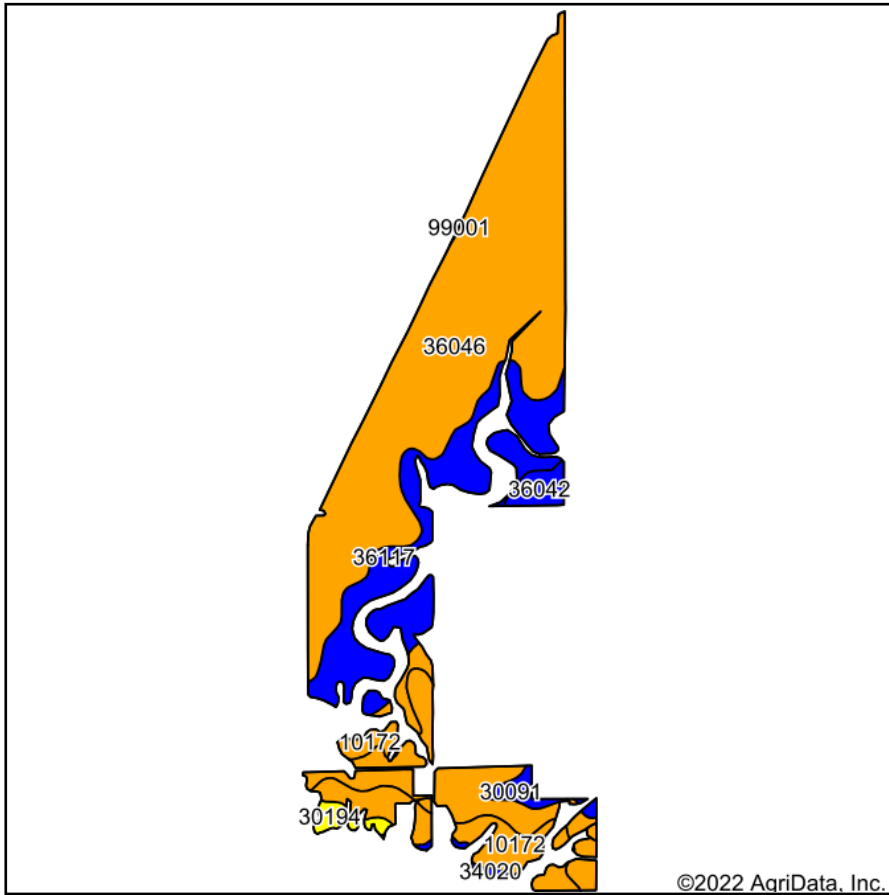

Soils data provided by USDA and NRCS.

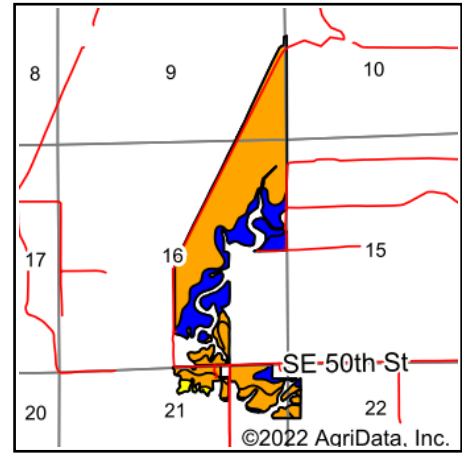

State: **Missouri**
 County: **Grundy**
 Location: **16-60N-24W**
 Township: **Jackson**
 Acres: **237.5**
 Date: **3/3/2022**

United Country
 Property Solutions, LLC

Maps Provided By:
surety
 CUSTOMIZED ONLINE MAPPING
 © AgriData, Inc. 2021 www.AgriDataInc.com



Area Symbol: MO079, Soil Area Version: 25

Code	Soil Description	Acres	Percent of field	Non-Irr Class Legend	Non-Irr Class *c	*n NCCPI Overall	*n NCCPI Corn	*n NCCPI Soybeans	
36046	Wabash silty clay, 0 to 2 percent slopes, occasionally flooded	130.76	55.1%		Illw	60	60	49	
36117	Nodaway silt loam, heavy till, 0 to 2 percent slopes, occasionally flooded	45.57	19.2%		Ilw	85	85	82	
30133	Lamoni clay loam, 5 to 9 percent slopes, eroded	26.54	11.2%		IIIe	60	60	48	
10172	Shelby clay loam, 9 to 14 percent slopes, moderately eroded	23.09	9.7%		IIIe	71	71	55	
36042	Vesser silt loam, 0 to 2 percent slopes, occasionally flooded	4.38	1.8%		Ilw	95	76	95	
30091	Grundy silty clay loam, 2 to 5 percent slopes, moderately eroded	3.38	1.4%		Ile	75	75	67	
30194	Shelby clay loam, 14 to 18 percent slopes, moderately eroded	2.77	1.2%		IVe	68	68	51	
34020	Colo silty clay loam, drainageway, 2 to 5 percent slopes, frequently flooded	1.01	0.4%		Ilw	78	78	59	
Weighted Average						2.78	*n 66.9	*n 66.5	*n 57

*n: The aggregation method is "Weighted Average using all components"

*c: Using Capabilities Class Dominant Condition Aggregation Method

Soils data provided by USDA and NRCS.