

Soils Map

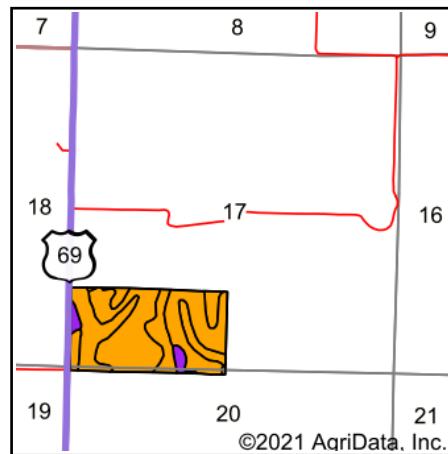
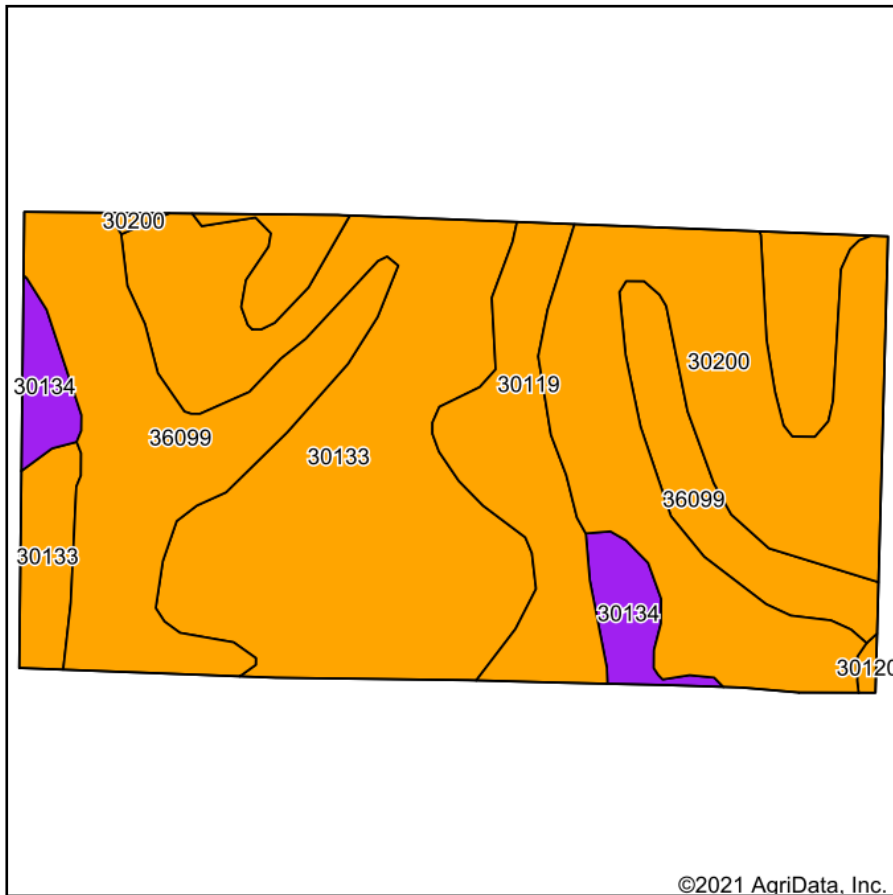

State: **Missouri**
 County: **Harrison**
 Location: **17-62N-28W**
 Township: **Cypress**
 Acres: **80.57**
 Date: **12/28/2021**

 United Country
 Property Solutions, LLC

Maps Provided By:

 surety
 CUSTOMIZED ONLINE MAPPING
 © AgriData, Inc. 2021 www.AgriDataInc.com



Soils data provided by USDA and NRCS.

Area Symbol: MO081, Soil Area Version: 25

Code	Soil Description	Acres	Percent of field	Non-Irr Class Legend	Non-Irr Class *c	Alfalfa hay Tons	Caucasian bluestem Tons	Common bermudagrass Tons	Orchardgrass red clover Tons	Tall fescue Tons	Warm season grasses Tons	*n NCCPI Overall	*n NCCPI Corn	*n NCCPI Soybeans
30133	Lamoni clay loam, 5 to 9 percent slopes, eroded	28.19	35.0%		IIIe							60	60	48
30200	Shelby loam, 9 to 14 percent slopes	19.87	24.7%		IIIe							74	74	62
36099	Zook-Colo silty clay loams, 1 to 3 percent slopes, frequently flooded	17.51	21.7%		IIIw			8	7	8	9	67	67	57
30119	Lagonda silty clay loam, 2 to 5 percent slopes, eroded	11.55	14.3%		IIIe							75	75	59
30134	Lamoni clay loam, 5 to 9 percent slopes, severely eroded	3.26	4.0%		VIe							58	58	38
30120	Lagonda silty clay loam, 5 to 9 percent slopes, eroded	0.19	0.2%		IIIe	5	8	7	8	7	8	70	69	60
Weighted Average					3.12	*-	*-	1.8	1.5	1.8	2	*n 67.1	*n 67.1	*n 54.6

*n: The aggregation method is "Weighted Average using all components"

*c: Using Capabilities Class Dominant Condition Aggregation Method

Soils data provided by USDA and NRCS.